

Union Station

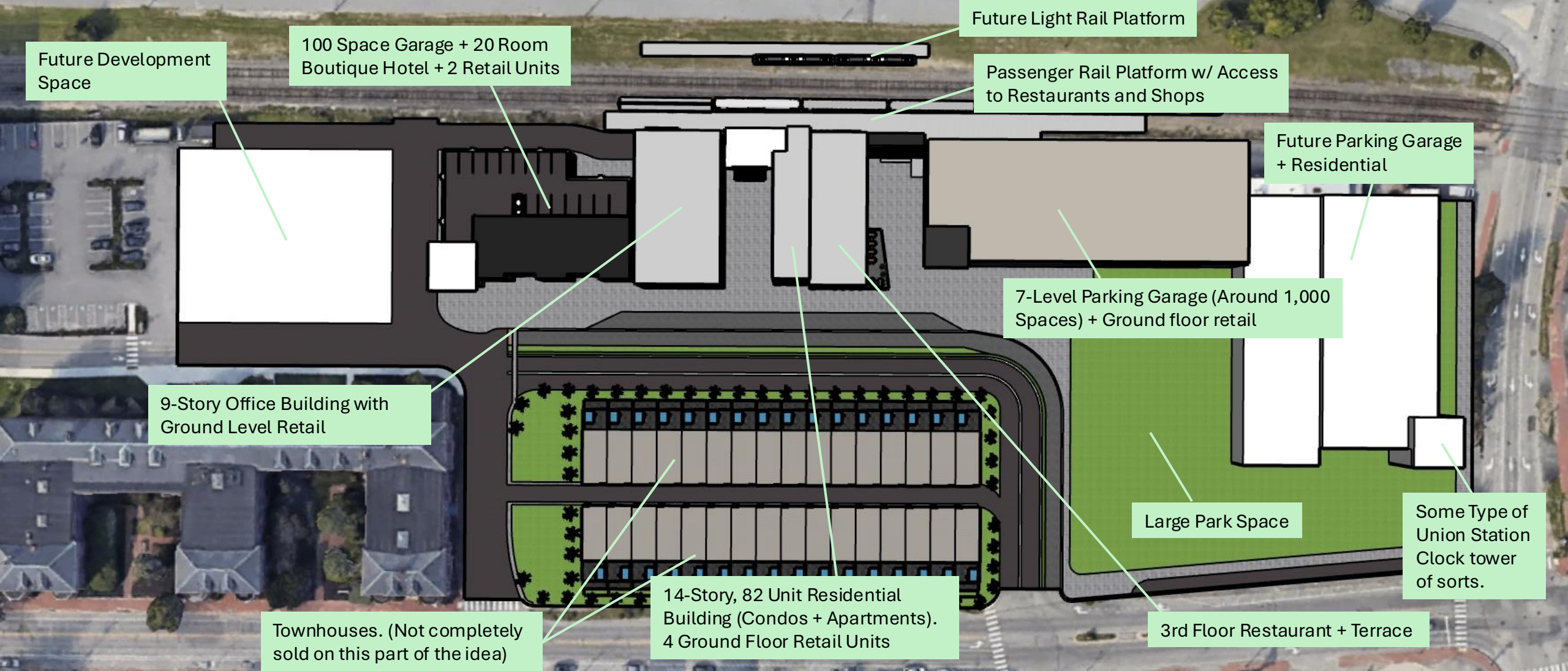

A Rough Idea and Scale of an upgrade for Portland's Union Station



Birds Eye View

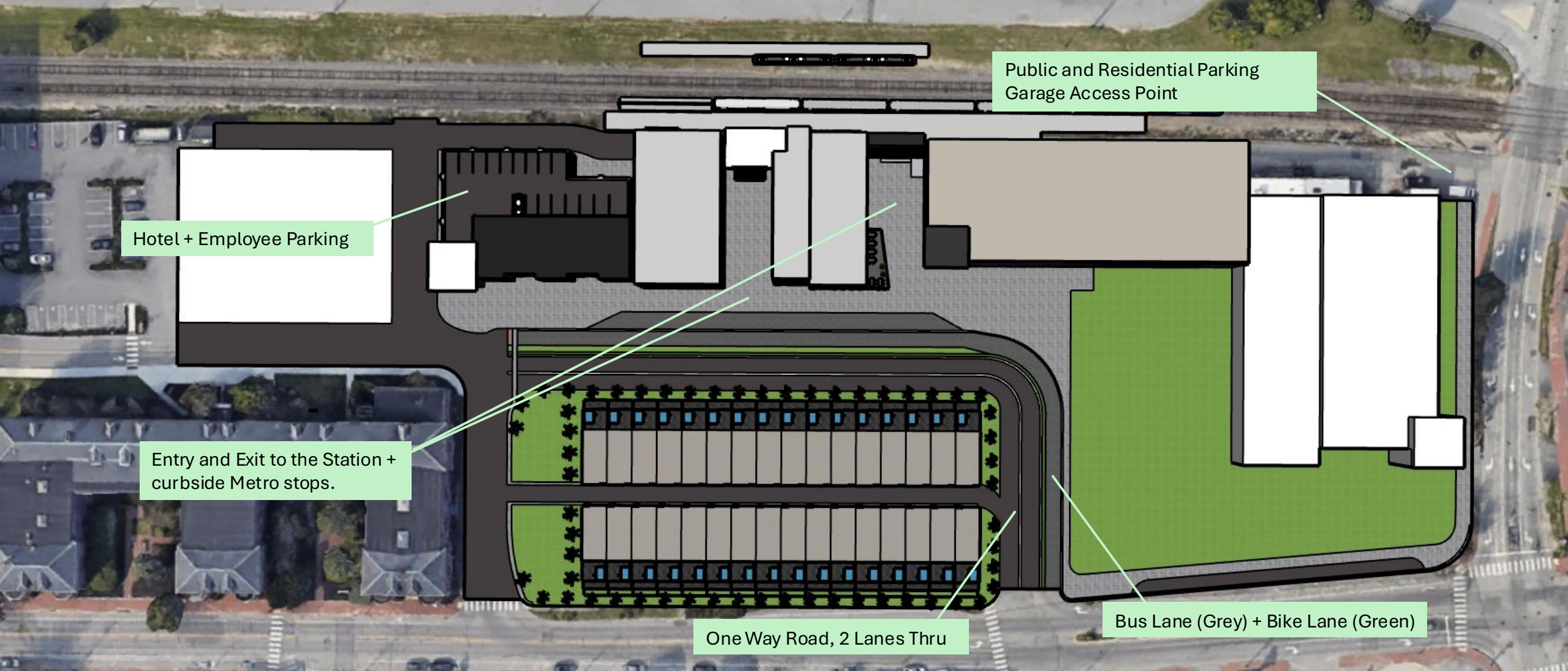

Birds Eye View

View as you enter the station loop road

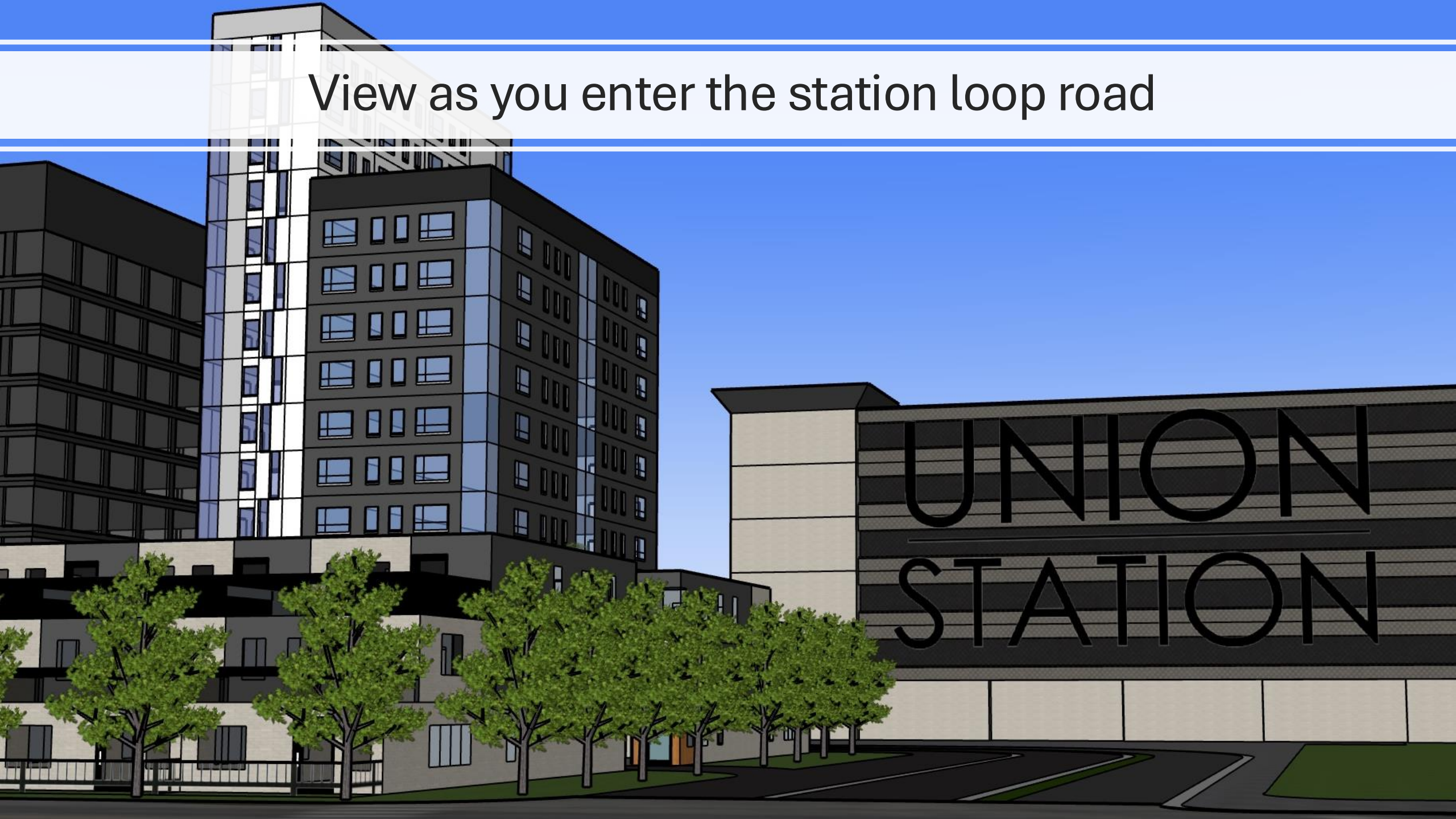



Entrance and Exit to the Station

Entrance (Left) Exit (Right)



A New Modest but Strong Skyline for Portland



Over 1,000 Jobs created from Start of Construction to Opening

Connecting Portland from Brunswick to Boston and beyond

Residents will be steps away from a commute to Boston or elsewhere in Maine, New Hampshire, or Massachusetts. New England will be minutes away from Portland's historic Old Port, professional sports events, hotels, conferences, work, and more.



An architectural rendering of a proposed development at Union Station. The scene includes a large, modern building with a flat roof and horizontal lines, labeled 'UNION STATION' in large, dark letters. To its left are several tall, multi-story buildings with dark facades and many windows. In the foreground, there's a parking lot with many cars, a row of trees, and a green lawn. In the background, there's a large, white, rectangular building with the words 'UNION STATION' on its side. The overall style is a mix of modern and historical architectural elements.

These white building outlines will pay tribute to the station that once was. A Clock Tower will be right on the corner of Congress and Saint John Street, in front of a parking garage, housing, and the large park space.

New and Improved look while paying tribute to the past



An innovative and progressing city gets its innovative and creative development

Let's keep creating opportunity for the younger generation. Let's keep leaving our home better than we found it. Let's make sure of a successful future of our one-of-a-kind community.

Union Station was destroyed... It has not seen a revival since. This project will bring connectivity, life, and opportunity back to this Portland neighborhood.



Keep Portland Advancing